

REPORT ON SUSTAINABILITY AND THE ENVIRONMENT

JANUARY 2020 - DECEMBER 2020



Cardiff
Metropolitan
University

Prifysgol
Metropolitan
Caerdydd



Sustainable Thinking
Meddwl Cynaliadwy

Cardiff Metropolitan University
Prifysgol Fetropolitan Caerdydd

TABLE OF CONTENTS

- O1. Foreword
- O2. Introduction
- O3. Policies, Standards and Benchmarks
- O4. Responsibilities
- O5. The University's Approach
- O6. Impact highlights
- O7. Sustainability Committee
- O8. Environment Management System ISO 14001
- O9. Conclusion
- 10. Focus for 2021



LEIGH ROBINSON

Pro-Vice Chancellor (PVC) Partnerships
and External Engagement

FOREWORD

Cardiff Metropolitan University's staff, students and stakeholders are committed to working together to establish the University as a leader in education for sustainable development. Embedded into our Sustainability Strategy and Sustainability and Environment policy, our work to achieve this is developed within an organisational culture that takes a proactive approach to sustainability in relation to all aspects of the University. Our vision is to embed a culture of sustainability and environmental stewardship amongst our communities. We are committed to the continual improvement of our sustainability efforts and environmental management by engaging with our staff, students and local communities to change behaviour, evidenced by the successful external audit of our Environmental Management System.

As shown in this report, despite the global pandemic, in 2020 we made significant progress in our actions and approach to sustainability. Over the past year, we have developed a Sustainability Engagement Strategy focusing on raising the profile of our sustainability activities and further engaging our staff, students and communities in our sustainability efforts. Our Global Academies were launched, to cohere our research around the Sustainable Development Goals, which will provide direction for our ongoing sustainability-focused research. Our Repair Cafes continued throughout lockdown, providing opportunities for staff, students and community to volunteer their repair skills, advice and expertise at the Repair Cafes on our campuses. At our Repair Cafes, 147 items were brought in for repair, with 110 repaired, saving these items from landfill. Our communities have continued to be involved, particularly through our regular litter picks from each campus. This not only involved over 120 participants, but was important in our application for Bronze Award for Hedgehog Friendly Campus in December 2020. We were finalists for three Green Gown Award 2020, focusing on Campus Health, Food and Drink, Benefitting Society and Next Generation Learning and Teaching – recognition of our institutional-wide approach sustainability.

We continue to remain committed to initiatives ranging from Fair Trade to the Well-being of the Future Generations Act. By working and studying in an organisation committed to sustainability and the environment, our students will become the next generation of global citizens able to conserve, champion and celebrate the planet we all share.

INTRODUCTION

During this reporting period we were faced with a global pandemic. The University campuses were first closed in March 2020 with the University moving from a state of Business Continuity Planning to Major Incident Planning. The University adopted and adapted UK and Welsh Government guidance and was informed by Public Health Wales guidance.

All staff able to work from home were instructed to do so with immediate effect, and all classroom-based and face-to-face teaching ceased with all teaching moving on-line. All assessments and exams on-line and all exam boards were held virtually.

From the outset of the pandemic, led by our Vice-Chancellor Professor Cara Aitchison, we've taken a values-driven compassionate approach, safeguarding the long-term wellbeing of staff and students above everything else. This stability has enabled us to remain secure, protect our people and placed us in the best possible position to help rebuild Wales when the time comes.

Some teaching activities on Campus were re-instated in between lockdown and firebreaks to enable externally supported face to face teaching to continue. Environment and Estates, Residences and Catering staff remained working on campus to maintain and provide key services. Extensive review and amendments to shared spaces, hand washing facilities, masks, hand sanitiser, screens, the employment of covid officers, direction of traffic floor markings etc. were implemented.

The University is committed to reporting on its progress towards meeting the targets set out in the Sustainability, Policy and Strategy. The Sustainability Strategy provides a framework to cohere our ambitions and actions in relation to sustainability and sustainable development.

This Annual Report (2020) reflects the progress we have made in the year of the launch of Cardiff Met's new Sustainability Strategy and celebrates achievements from across Cardiff Met, highlighting work we have done to comply with our targets and objectives for ISO 14001 and work completed by the Sustainability Committee.

In November 2019, students, staff and the Board of Governors were informed of the plan to commit to becoming a Net Zero Carbon organisation by 2030. The Cardiff Met Carbon Zero reduction strategy document will be aligned with that of Cardiff Council.

A new Estates Masterplan, providing significant investment into the existing campuses. The first redevelopment programme will cover the period to September 2026 and comprise a mix of new build developments, refurbishment and reuse of existing facilities and public realm improvements. As part of our aim to meet the Net Zero Carbon Commitments, it is expected that all refurbishment projects will need to achieve high standards, while new builds will need to meet BREEAM excellent rating as a minimum.





POLICIES, STANDARDS AND BENCHMARKS

The University's work on the environment and sustainability is guided by an Environment and Sustainability Policy:

The University has engaged, consulted and reviewed all linked supporting policies to ensure they align with the aims of the Environmental & Sustainability Policy, Ethical Investment, Energy & Carbon Management, Ethical Supply Chain, Fairtrade, Sustainable Food, Sustainable Procurement and Sustainable Seafood.

The University has a Sustainability Strategy, Sustainability Engagement Strategy and Working Together Civic Engagement Strategy.

The University participates in the People and Planet Green League. The University will continue to use this league table as a measure of its performance in addition to its Carbon Net Zero Plans. The most recent league table was published in 2019.

The University has successfully maintained its certification ISO 14001 standard, having first achieved it in 2012, and successfully transitioning to the 2015 standard in 2017.

RESPONSIBILITIES

The Pro Vice Chancellor (PVC) Partnerships and External Engagement has responsibility for environmental performance and sustainability. The Sustainability Committee meets termly and reports to the University's Management Board.

This work is co-ordinated through the Sustainability Committee, with representatives from each School, Aspect Owners, Students' Union and Unions.

The Environmental Management System (EMS) covers all University activities from energy and utilities, to waste management and recycling. Most significantly, the work includes embedding education for sustainable development in the curriculum, into research and enterprise activities and behavioural change / awareness.

The University works closely with the Students' Union to maintain the EMS. The Students' Union leads the University FairTrade status and is the vital link to all student activities on Campus.



THE UNIVERSITY'S APPROACH

The University takes its environmental responsibilities seriously and aims to manage its operations in ways that are environmentally sustainable, economically feasible and socially responsible. It continues to embed and raise environmental awareness through the development and training of its employees and enabling students to explore and develop values, skills and knowledge of sustainability through research, curricular and extracurricular activities.

The aim is to develop a socially cohesive, environmentally responsible and all-inclusive work and study environment, which looks to engage staff, students and the wider community.

As part of its commitment to raising the awareness of sustainability and engaging staff to make a difference. The Sustainability Engagement Strategy defines objectives and opportunities for involvement. The University has an on-line, e-Learning module, which can be accessed by all staff as part of their induction and staff development process. This course introduces staff to the topic of sustainability and policies of the University and is a compulsory part of all new staff's corporate induction into the University.

The review and creation of web pages for all Sustainability activities provides staff, students, prospective students and the community with information on progress, achievements, news and planned activities. Social Media and the internal news platforms InSite and MetCentral are critical to sharing news and events.

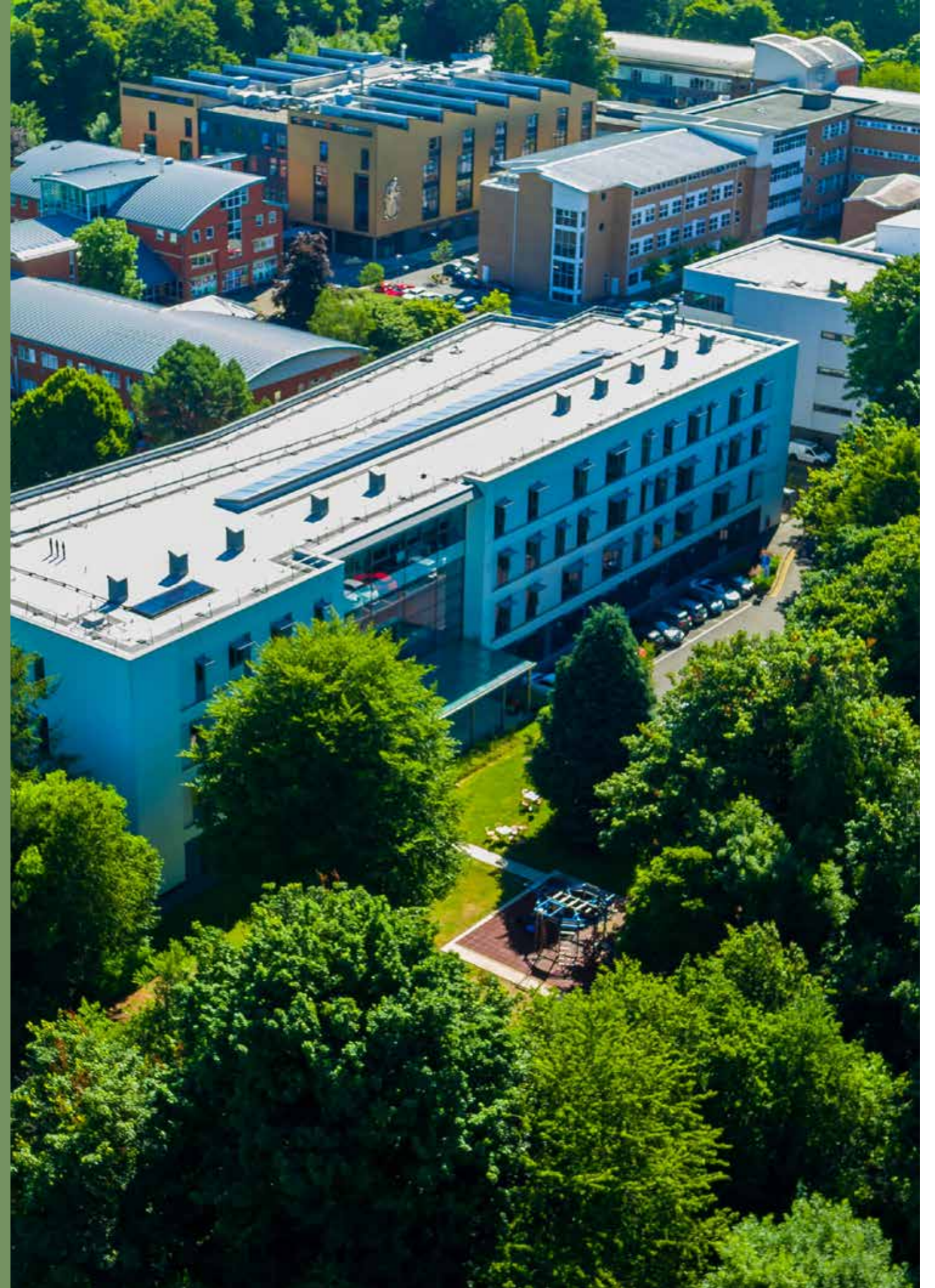

IMPACT AND HIGHLIGHTS

During the period, the University carried out a significant number of activities and actions that promote sustainability and the environment.



ENVIRONMENTAL AWARENESS

Creation of a new Sustainability Engagement Strategy that provides opportunities for students to be trained and participate in Environmental Auditing.

This activity is recorded on the students' an addition to their (HEAR) Higher Education Achievement Report statement.

Established a new Sustainability Committee Focus Group, to provided staff and students to engage with the review of all sustainability strategies and policies.

Continued Free Green Workshops for staff and students which provided, taster sessions of green living opportunities, e.g Soap Making, Wasteless Home and Bathroom, delivered safely via virtual rooms.

Held "Go Green Week" on campus, which is a selection of information stalls to inform and change environmental behaviour, e.g. Vegan curry tasting, Ecoegg products, Green Smoothie tasting, Fairtrade products, Book swap, Gift swap, clothes collection for YMCA, plants and volunteering / engagement opportunities.

Held "Fairtrade Fortnight" with promotional stalls, information stands and SU / Global Engagement, this also included a Fairtrade Football 5 a side competition.

Continued to promote the move away from single use coffee cups with a lecture, "the highs, the lows and the future" delivered to Sustainable Food students with a lecture on Campus and virtually in November 2020 to staff and students.

The Students' Union appointed a dedicated Environmental Officer.

Held Repair Cafes on Campus with staff/students and the community to bring broken items for our repair volunteers to fix , saving items from landfill and providing advice and expertise to help people to consider future repair/re-use opportunities.

Launched the Hedgehog Friendly Campus initiative – working towards Bronze level.

Continued Community events for staff, students and local community, such as litter picks near and around campus. The University is a Litter Picking Hub for Keep Wales Tidy, for the booking out of equipment and registering of litter picking details.

Signed an agreement with WRAP to reduce food waste on Campus using their Foodwaste Roadmap (WRAP is a global NGO based in the UK. It is one of the UK's top 5 environmental charities and works with governments, businesses and individuals to ensure that the world's natural resources are used sustainably) – the first University to sign up to the delivery of the UK Food Waste Reduction (FWR) Roadmap – to embed the principles of target, measure, act within our food operations. (The Food Waste Reduction Roadmap to help the UK achieve both the (UK) Courtauld Commitment 2025 targets, and the (international) United Nations' Sustainable Development Goal (SDG) 12.3. The Roadmap is hugely ambitious, and the UK is the first country in the world to set a nation-wide plan of this size, scale and ambition.

Completed of 33 internal audits, some as desktop exercises

Reviewed the Terms of Reference of Sustainability Committee

Continued Business in Action module – Real World project on Single use coffee cups v Re-usables on Campus

Gave lecture on ISO 14001 at Cardiff Met to Tourism on a Small Planet students and Sustainable Food students

Created Hedgehog Friendly Campus working group for the implementation of the Bronze Award



VOLUNTEERING

Relaunched Environmental Champions with Cardiff Digs, Students attended an introductory session to meet up and make a macramé hanging planter

Established Volunteering Forum with Cardiff Digs for student volunteering opportunities in the community

Opportunities to volunteer with Friendly Campus working group

Staff/ students and community volunteered their repair skills at the Repair Cafes on campus saving items from landfill, providing advice and expertise.

EXTERNAL AWARDS

Shortlisted finalist for three Green Gown Award 2020 submissions - Finalist – October 2020 :

- Campus Health, Food & Drink;
- Benefitting Society
- Next Generation Learning & teaching

Submission of application for Bronze Award for Hedgehog Friendly Campus in Dec 2020

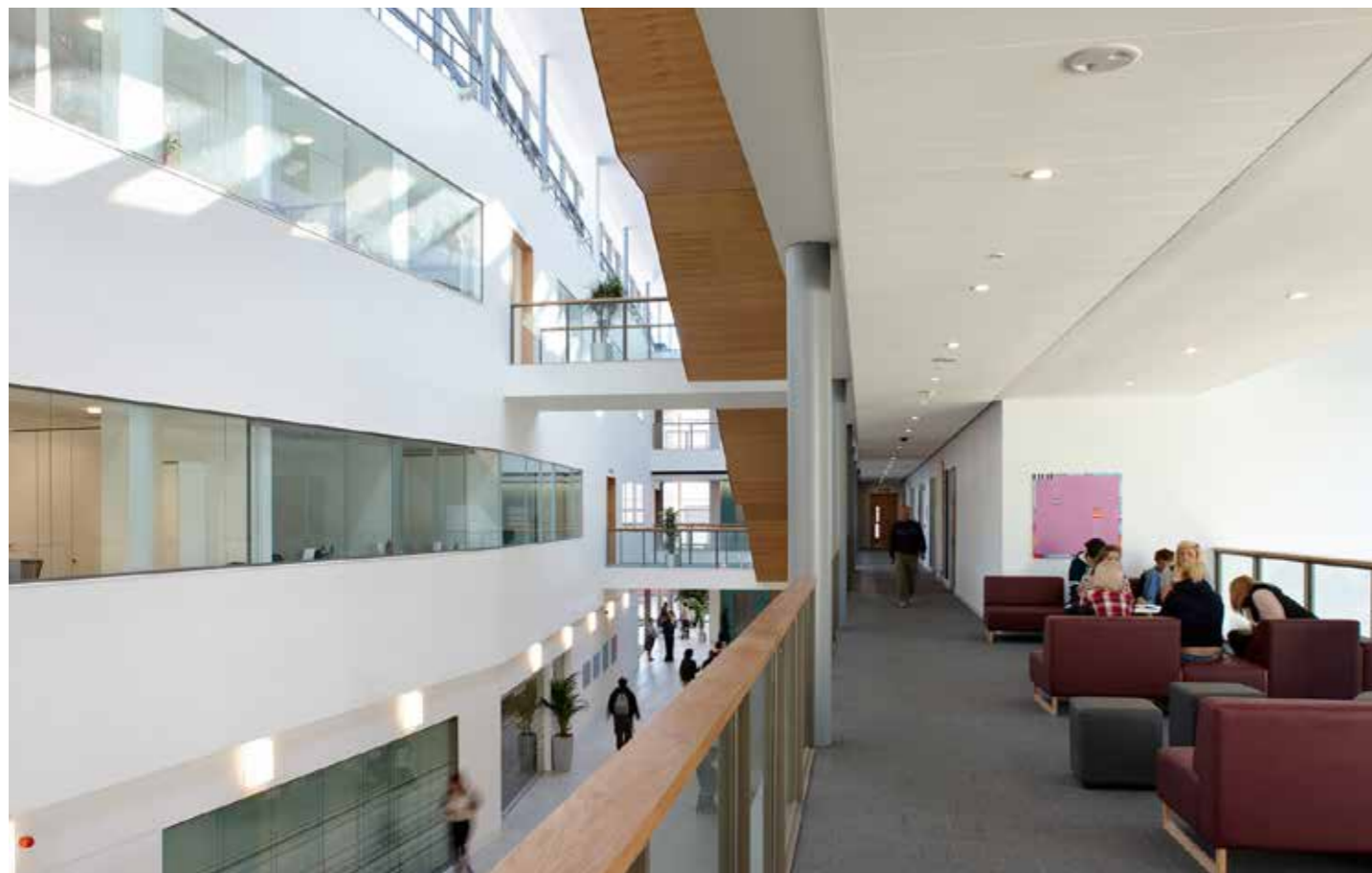

CONSUMPTION / USE OF RESOURCES

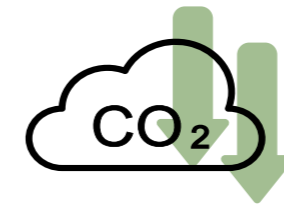

18%

Overall energy emission reduced by 18% compared to the previous year from a total of 3,796 tCO2e to 3,284 tCO2e

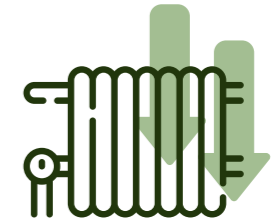

13.3%

Overall energy consumption has decreased by 13.3% due to reductions in electricity from reduced occupancy and building use.

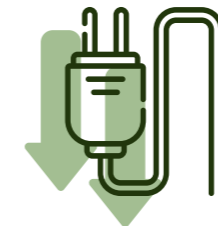

15%

Electricity consumption reduced by 15%.

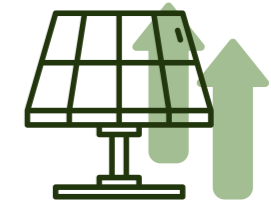

0.4%

Renewable energy generation from Solar PV amounted to 45,220kwh and accounts for 0.4% of total University electricity demand.

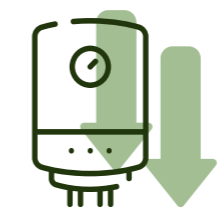

12%

Absolute Gas consumption reduced by 12% as a result of reduced demand over the spring period and managed heating of occupied buildings only.

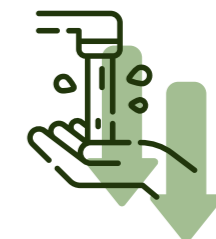

3%

Water consumption reduced by 3%.

DIVERTED

The University continues to send all of its General Waste (termed as Diverted Waste) that cannot be recycled, via one of the several established recycling routes utilised by the University, to the Trident Facility in Cardiff Bay for energy from waste processing. The University does not send any of its waste to Landfill.

CARBON NET ZERO

Gap analysis carried out to inform the development of a detailed Inventory to establish a carbon emissions baseline to support aspirations and the strategy for Net Zero 2030, to include Scope 3 emissions inventories.

RECYCLED

Continued a trial with Keep Wales Tidy, with a new waste stream for the collection of single use cups on Campus for Jan – March.

REPAIRED

During the four Repair Cafes held on Campus, 147 items were brought in for repair, with 110 repairs.

TRAVELLED



Introduction of NEXT Bike cycle hire scheme on all campuses, with the increased access to 1200 free passes for students and staff for 2019/20.

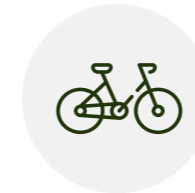

Cycle to work purchase scheme June – Sept 2020, 29 staff members purchased bikes / equipment through the scheme.



MAINTAINED

106 bikes were serviced for free bike for staff, students and local community during January and February Community Days, Go Green Week, and November 2020.

Successful External Audit of EMS in January 2020.

All environmental legislation has been complied with, with the addition of an internal audit on the impact of the pandemic on the Environmental Management System completed.



IMPROVEMENTS

Introduction of Next Bikes to each academic and residential campus

The reduction of single use plastic for food and drink containers throughout the University Catering Service

Increase in reusable cups being presented in Catering outlets since the Jan 2019 start of the Cup pilot project. Raising awareness that the single use cups cannot be recycled easily has changed behaviour. Progress can be made when we can all return to campus – to remind all to use reusables for discounts. We now have both internal and external single use coffee cup collection points on Llandaff Campus to collect cups on the go.

The implementation of regular litter picks from each campus resulted in picks in January, February and November 2020 with 126 participants.

Review of staff Sustainability Induction e-module

Delivered an Interactive Hedgehog Friendly Workshop virtually to complete Hedgehog surveys in staff and student homes during lockdown

Enactus Society improvements

Fairtrade Steering Group set-up for renewal and Fairtrade SMART Action Plan created

Cardiff Met's official launch of the first three Global Academies.

SUSTAINABILITY COMMITTEE

The Sustainability Committee meets on a termly basis. The terms of reference were confirmed at the start of the academic year with the addition of School representation, Students' Union and Trade Union. The Committee aims to :

Provide strategic direction and oversight of the University's sustainability ambitions.

Review and monitor progress against the objectives of the University's Sustainability strategy and guidance on further actions and initiatives to achieve objectives.

Promote a culture of continuous improvement in sustainability through identification and sharing of actions and initiatives that embed sustainability principles and deliver positive outcomes across the University.

Ensure the effective and efficient operation of the Sustainability Policy.

Ensure compliance to the Environmental Management System – ISO14001.

Oversee the achievement of sustainability accreditations and awards, such as the People and Planet University Green League.



ENVIRONMENTAL MANAGEMENT SYSTEM

ISO 14001

Our Environmental Management System – ISO14001, is defined by the aspects of the University's activities that have the potential to impact upon the environment. The University sets objectives and targets for improvements and reports progress at the termly Sustainability Committee.

The foundation of our Environmental Management System is an understanding of and compliance with relevant environmental legislation and other compliance regulations. We have a Register of Legislation applicable to the University's activities, with the Sustainability Engagement Manager keeping the Register up to date. This includes monthly updates to changes to existing legislation and new legislation via an annual subscription to legal register software and newsletter. Legal Compliance is reviewed monthly, aspects owners are advised of changes and in totality annually as part of the internal audit process to evaluate compliance. We continue to develop our approach to sustainability via the Sustainability Committee, adapting to new approaches in sustainability, engagement in changing policy, legislation, the interests of our stakeholders, environmental and societal responsibilities and our targets and objectives.

An audit of the Environmental Management System impacts of the pandemic was completed in April 2020. All Campus based activities ceased for a short time, except for key workers from the UK Government instruction for lockdown. Hand sanitising, desk cleaning and home working were in place prior to social distance measures. The EMS has environmental aspects and nominated fourteen individual Aspect Owners with key responsibilities as part of the Environmental Management System. Each of these areas report target and objectives progress to the Sustainability Committee.



ENVIRONMENTAL 2020 – 2022/23
TARGETS AND OBJECTIVES PART OF EMS
 ISO14001:2015 (measured against EMS baseline data)

SUSTAINABLE FOOD

Objective

Limit the impact of food purchasing

Target

To progress Sustainable Restaurant Association feedback report and Soil Association accreditation.

To review food offer across the University's (and CMSU's) catering outlets.

Engage with CSSHS (Nutrition and Dietetics) Real World project to support development of new product (food) development at University catering outlets.

Enhance involvement with the Sustainable Food City initiative.

Continue to review impact on Waste Management Strategy.

Indicators

To improve scoring of 78% and 3 stars for Sustainable Restaurant Association and achieve Soil Association Accreditation.

Continue to review single use plastic use at all outlets. Measure of re-usables with hot drink purchases and single use cups collected for recycling and number of free water vends. Food waste and food prep data to be collated for WRAP.

Responsibility

Catering & Hospitality Manager

April 2020



Received a gold award by the Sustainable Restaurant Association in September 2019.



Nominated as one of the top 20 sustainable businesses by the SRA in 2019.

Menus and food offer have been updated in September to include the following:

More healthy & vegan lines available on the menu every day through the two food courts on campus

Vegan and healthier sandwich options also available every day through the 6 catering venues on campus

Actively support and promote healthier eating options through the hospitality service

Healthy options becoming part of the day to day menu cycle.

Signed pledge for the Peas Please/ veg pledge campaign to add more vegetables into our menus with the Food Cardiff group. <http://foodfoundation.org.uk/peasplease/>

Actively supported Global week 2019/20 to increase the range of international dishes on the menu at both campuses

Continue to sell and promote reusables chilly bottle/mugs /food containers to further reduce the amount plastic used on campus

Introduced dedicated vegan station in the K1 restaurant so a vegan choice is available on the menu every day.

Vegan pop day in the CSM Atrium in February 2020

Go green day Vegan pop up lunch – very popular with staff and students on campus

Working with the Soil association and working towards their accreditation. Currently on hold due to Covid.

August 2020

Menus and food offer have been updated ready for the September 2020 intake to include the following :

More healthy & vegan lines available on the menu every day through the two food courts

Vegan and healthier sandwich options also available every day through the 6 catering venues on Campus

Actively support and promote healthier eating options through the hospitality service

Healthy options becoming part of the day to day menu cycle.

Signed pledge for the Peas Please/ veg pledge campaign to add more vegetables into our menus with the Food Cardiff group.
<http://foodfoundation.org.uk/peasplease/>



Jan 2021

Received a gold award by the Sustainable Restaurant Association in September 2019. Nominated as one of the top 20 sustainable businesses by the SRA in 2019.

Menus and food offer have been updated ready for the September 2020 intake to include the following:

Healthier & vegan lines available on the menu every day through the two food courts on campus

Vegan and healthier sandwich options also available every day through the 6 catering venues on campus

Actively support and promote healthier eating options through the hospitality service

Healthy options becoming part of the day-to-day menu cycle.

Signed pledge for the Peas Please/ veg pledge campaign to add more vegetables into our menus with the Food Cardiff group.
<http://foodfoundation.org.uk/peasplease/>

Actively support Global and go green week 2020/21 to raise awareness to international cuisine and culture and green

Continue to sell and promote reusables chilly bottle/mugs /food containers to further reduce the amount plastic used on campus (this will be introduced again once social distancing is removed)

Introduced dedicated vegan station in the K1 restaurant so a vegan choice is available on the menu every day. Working with the Soil association and working towards their accreditation. Currently on hold due to Covid.

WASTE MANAGEMENT

Objective

Reduce waste and increase awareness

Target

Reduce total number of bins across Campuses and standardise to support clear message on Recycling (survey pre – March 2020 and post July 2020).

To remove all Glass and Food waste from Halls Recycling (DMR) and General Waste streams at Cyncoed and Plas Gwyn by July 2020 (current contamination level to zero – Record reported incidents to date and measure against reported incidents as at July 2020).

To make all Staff, Students and Visitors aware of the Recycling and Re-use facilities at the University (surveys of Students and Staff to be undertaken during March 2020 and again June 2020).

Indicators

Audit of bin locations and numbers March 2020 and survey review data.

Record reported incidents to date and measure against reported incidents as at July 2020.

Record of awareness activities and survey results.

Maintain zero waste to landfill and work towards Welsh Government's target of recycling 70% of our waste by 2025.

Responsibility

Head of Campus Services

April 2020

Environment and Estates Budgeting – To fund changeover of bins (cost paper to be submitted).

Support from Sustainability Engagement Manager - To recruit Students to assist with Bin audits and establish the best way to engage with new and existing students on driving performance on Recycling.

SU / Catering – Support to enforce the message on Recycling (following changeover of bins and provision of comms materials)



August 2020

Reduce total number of bins across Campuses and standardise to support clear message on Recycling (survey pre – March 2020 and post July 2020).

Process has started at Cyncoed as there is a greater mix of types of bins there, focussing on external bins initially. Aim to re-purpose the existing 'Cardiff Met Blue' single bins to support action point 2. Meeting with Fab Lab to scope re-purposing of these bins to create Glass bins that will be safe for Student use and for Gavin Jones to easily empty has been delayed due to current Covid-19 crisis. Contact has now been made with Fab Lab to progress scoping of this work, delivery of a sample bin will be completed week commencing 4th May.

The cost of replacement to the Dual type bins is significant; given the current crisis, consideration is to be first given to relocating dual type bins from Llandaff – if quantities permit. This will delay the changeover.

The current Waste Management contract will be extended for 1 year from August 2020, discussions ongoing with contractor to scope the reduction of collection frequency / size of bins etc. to reflect reduced demand from a reduced physical Staff and Student presence on Campus. Potential saving could be re-directed to fund the changeover of external bins outlined above.

Action

Paper to be submitted to Director of Environment and Estates detailing total cost and efficiency saving from Waste contract for consideration before progressing ordering of replacement bins.

To remove all Glass and Food waste from Halls Recycling (DMR) and General Waste streams at Cyncoed and Plas Gwyn by July 2020 (current contamination level to zero – Record reported incidents to date and measure against reported incidents as at July 2020)

Implementation of Food waste recycling has progressed at Plas Gwyn, some issues with missed collections that have been addressed with the contractor emphasising the importance of ensuring that this does not happen regularly as it could lead to overflow and pest control issues, and subsequently ceasing of the recycling of food waste. Food waste collection at Cyncoed to be rolled out once the pilot at Plas Gwyn has been approved; now aiming for implementation in readiness for start of next Academic year. Implementing Glass recycling at Cyncoed via use of repurposed bins on Campus to be implemented if scoping by Campus Services and Fab Lab is successful. Cost for new Glass bins will be included in the cost paper referenced in Target 1 above.

To make all Staff, Students and Visitors aware of the Recycling and Re-use facilities at the University (surveys of Students and Staff to be undertaken during March 2020 and again June 2020) Increased activity on Social Media (Twitter account CMetRecycling) to support environmental behaviour. Surveys to establish baseline on Staff and Student understanding of existing facilities delayed, this will now be undertaken around July time for staff. Key information sought is what do staff think they can recycle and how they can do that within the University, and also what would encourage staff to recycle more. Reverse Vending machine (Plastic bottles) is now ready for delivery to Llandaff Campus, awaiting confirmation of delivery date to facilitate its locating within Zen. Agreement with CMET Catering and SU that this will be a non-incentivised pilot, going forward potential to incentivise via discount on outlets – logistical issue to resolve in respect of where the discounts will apply, action to be taken forward however has support in principle from both CMET and SU.

Jan 2021

Reduce total number of bins across Campuses and standardise to support clear message on Recycling (survey pre – March 2020 and post July 2020).

The cost of replacement to the Dual type bins is significant; given the current crisis, consideration is to be first given to relocating dual type bins from Llandaff – if quantities permit. This will delay the changeover. The current Waste Management contract will be extended for 1 year from August 2020, discussions ongoing with contractor to scope the reduction of collection frequency / size of bins etc. to reflect reduced demand from a reduced physical Staff and Student presence on Campus. Potential saving could be re-directed to fund the changeover of external bins outlined above. Action – Paper to be submitted to Director of Environment and Estates detailing total cost and efficiency saving from Waste contract for consideration before progressing ordering of replacement bins. Completed, £8k saving achieved on Waste contract due to reduced volumes of waste and collection frequencies has been utilised to fund the purchase of new Bins at Cyncoed Campus. Bins received on Campus 6th January 2021, now being issued, some require installation (bolting to floor).

New Action

Recycling posters to be refreshed across the Campuses, focussing on areas that remain in use during the Pandemic.

To remove all Glass and Food waste from Halls Recycling (DMR) and General Waste streams at Cyncoed and Plas Gwyn by July 2020 (current contamination level to zero – Record reported incidents to date and measure against reported incidents as at July 2020) Implementation of Food waste recycling has progressed at Plas Gwyn, some issues with missed collections that have been addressed with the contractor emphasising the importance of ensuring that this does not happen regularly as it could lead to overflow and pest control issues, and subsequently ceasing of the recycling of food waste. Food waste collection at Cyncoed to be rolled out once the pilot at Plas Gwyn has been approved; now aiming for implementation in readiness for start of next Academic year. Implementing Glass recycling at Cyncoed via use of repurposed bins on Campus to be implemented if scoping by Campus Services and Fab Lab is successful. Cost for new Glass bins will be included in the cost paper referenced in Target 1 above. Completed. Glass bins received 6th January 2021, now being installed (bolted to the floor for safety reasons) outside Halls alongside each existing Bin Corral, once installation completed Residential Students will be advised to use these instead of placing Glass bottles / Jars in the Black bag waste.

To make all Staff, Students and Visitors aware of the Recycling and Re-use facilities at the University (surveys of Students and Staff to be undertaken during March 2020 and again June 2020) Increased activity on Social Media (Twitter account CMetRecycling) to support environmental behaviour. Surveys to establish baseline on Staff and Student understanding of existing facilities delayed, this will now be undertaken around July time for staff. Key information sought is what do staff think they can recycle and how they can do that within the University, and also what would encourage staff to recycle more. Reverse Vending machine (Plastic bottles) is now ready for delivery to Llandaff Campus, awaiting confirmation of delivery date to facilitate its locating within Zen. Agreement with CMET Catering and SU that this will be a non-incentivised pilot, going forward potential to incentivise via discount on outlets – logistical issue to resolve in respect of where the discounts will apply, action to be taken forward however has support in principle from both CMET and SU. Incomplete - Carried forward. Due to reduced footfall on Campus, Catering facilities have been scaled down resulting in the Reverse Vending pilot not being rolled out. Closure of P Block SU area (location of the Reverse Vending machine) has since closed. New Action: Re-located Reverse Vending Machine to Cyncoed Campus, in consultation with SU / CMET Catering, to either Bench or Zen. Once complete, re-marketing of the facility to be progressed.

TRAVEL & TRANSPORT

Objective

Minimise the negative environmental impact of University related travel & transport

Target

WALKING

To increase student and staff walking to campus by 3% and 5% respectively over the next two years to have 30% of students and a fifth of staff walking to campus.

To measure results via the biennial Student & Staff Travel Survey, scheduled for November 2020.

CYCLING

To increase cycling to campus as a preferred mode to single occupancy car use via exploring the opportunity to become part of Cardiff Councils 'Cycle Super- Highway' planned for 2023.

To increase cycling at Llandaff Campus from 14.08% to 20% in annual 2% increments over the next three years.

To expand the cycle storage facilities at both Llandaff and Campus before 2023.

MET RIDER

To migrate to an app based Met Rider pass for September 2020.

To explore having more public bus services delivering to Llandaff Campus through open bus access to the front of Llandaff Campus.

To increase Rider patronage amongst both students and staff by 5% in total over the next three years.

Indicators

WALKING

November 2018 survey indicated that currently 27% of students and 15% of staff walk to campus.

CYCLING

To be assessed via the Student & Staff Travel Survey and via cycle storage/changing card access requests.

MET RIDER

To be assessed via annual sales figures.

Responsibility

Travel Plan Manager

April 2020

Travel Plan completed and awaiting forward from VC. Cycle to Work Scheme on pause due to C19 but will be re-launched on return to normal business. Proposal to increase voucher to £2k and hold two windows. Cardiff Bus meeting on 27/04/20 to discuss progression to app based ticketing FE HE South Wales Travel Group meeting scheduled for November 2020 Launch of staff student travel survey – November 2020.

August 2020

Expansion of Cycle To Work Scheme to £2k ceiling. Facilitating the purchase of electric bicycles. Scheme concluded in September with 28 participants. Second purchase to help facilitate furloughed staff scheduled for March 2021.

Met Rider service suspended in line with Covid 19 issues and Government advice to avoid public transport following approval by VCEG. Consultation on 2021/22 service to resume in February 2021 with Cardiff bus. Partial refund of Rider passes 2019/20 due to cessation of service completed with 575 applications processed.

Plans for Super Highway travelling along the perimeter of Llandaff Campus and proposed making pedestrian the centre of the campus to be revisited in February 2021

NEXT Bike – membership increased to 5,000 permits and additional stands installed at Llandaff Campus.

Proposal to be an e-bike station once launched in Cardiff to be explored in new year.

Faxi Scheme on hold presently due to obvious Covid 19 complications associated with car sharing to be revisited in new year.

Explore e vehicle charging points on campus as a response to increasing demand amongst staff.

Due to increased numbers of staff working from home and a reduction of students to campus, part of front car park allocated to student parking.

Cycle store in Llandaff quad relocated to make way for outside social areas.

Bike MOT's undertaken on all campuses with a positive response from students and staff alike. To be repeated in new year

Jan 2021

Expansion of Cycle To Work Scheme to £2k ceiling. Facilitating the purchase of electric bicycles. Scheme concluded in September with 28 participants. Second purchase to help facilitate furloughed staff scheduled for March 2021

Met Rider service suspended in line with Covid 19 issues and Government advice to avoid public transport following approval by VCEG. Consultation on 2021/22 service to resume in February 2021 with Cardiff bus. Partial refund of Rider passes 2019/20 due to cessation of service completed with 575 applications processed.

Plans for Super Highway travelling along the perimeter of Llandaff Campus and proposed making pedestrian the centre of the campus to be revisited in February 2021

NEXT Bike – membership increased to 5,000 permits and additional stands installed at Llandaff Campus.

Proposal to be an e-bike station once launched in Cardiff to be explored in new year.

Faxi Scheme on hold presently due to obvious Covid 19 complications associated with car sharing to be revisited in new year.

Explore e vehicle charging points on campus as a response to increasing demand amongst staff.

Due to increased numbers of staff working from home and a reduction of students to campus, part of front car park allocated to student parking.

Cycle store in Llandaff quad relocated to make way for outside social areas.

Bike MOT's undertaken on all campuses with a positive response from students and staff alike. To be repeated in new year

SUSTAINABLE PROCUREMENT

Objective

Through applying sustainable procurement principles and practices, the University aims to meet its need for products and services in a way that achieves value for money, yet delivers the most positive social, environmental and economic impacts possible throughout the entire life cycle of whatever has been procured

Target

To embed sustainable procurement practices is all key stages of the procurement lifecycle process.

Indicators

Programme of engagement with prospective, new and existing suppliers that sets out Cardiff Met's expectations in regards all aspects of sustainable supply chains.

Implemented during the first half of 2020. Indicators of engagement and success for this programme will include:

100% of all suppliers bidding for Cardiff Met contracts

100% of all new suppliers engaged by the University

Proactive sustainability engagement resulting in the identification of new sustainability opportunities and active enhancements across the key suppliers in the Universities top 10 sustainability risk commodities as identified through the Higher Education Procurement Academy ('HEPA') Commodity Risk Sustainability Assessment profile.

Numbers of new suppliers and % who respond to the sustainable procurement aspect

% of suppliers asked who engage in the self-declaration process.

Identifying, recording of and reporting on tangible benefits and successes across the supply chains.

% of 'high risk commodities' where commodity specific sustainability strategies and guidance exists.

Responsibility

Head of Procurement

April 2020

Sustainable Supply chain policy has been updated.

New Sustainable Supply chains documentation has been drafted that consolidates and updates previous information and addresses all aspects of sustainability in supply chains, including environmental, equality & diversity, fair employment and discrimination. This documentation will be used in all tender exercises, with a light-touch version utilised where appropriate.

Versions of this documentation are being tailored to suit 'new' applications: in the engagement with all new suppliers; a planned revision of the University contract management process; and an annual update process for a broader range of suppliers than currently covered by the formal contract management process.

Once complete, this process will enable the introduction of supplier engagement and response targets.

The University has adopted a UK HE sector sustainability risk assessment profile and has mapped the University's top risk commodities. Preparations are under way for the development of specific commodity guidance for these high risk categories.

August 2020

Sustainable Supply chain policy has been updated.

New Sustainable Supply chains documentation has been drafted that consolidates and updates previous information and addresses all aspects of sustainability in supply chains, including environmental, equality & diversity, fair employment and discrimination. This documentation will be used in all tender exercises, with a light-touch version utilised where appropriate.

Versions of this documentation are being tailored to suit 'new' applications: in the engagement with all new suppliers; a planned revision of the University contract management process; and an annual update process for a broader range of suppliers than currently covered by the formal contract management process.

Once complete, this process will enable the introduction of supplier engagement and response targets.

The University has adopted a UK HE sector sustainability risk assessment profile and has mapped the University's top risk commodities. Preparations are under way for the development of specific commodity guidance for these high risk categories.



Jan 2021

Updated Supplier record creation and engagement' process being finalized and prepared to be built into the Agresso MS7 system workflows. This will enable enhanced levels of detail of supplier activity in all aspects of sustainability to be captured as soon as they start engaging with Cardiff Met.

Once complete, this process will enable the introduction of supplier engagement and response targets.

The University has adopted a UK HE sector sustainability risk assessment profile and has mapped the University's top risk commodities. Preparations are under way for the development of specific commodity guidance for these high risk categories.

Utilisation of the new business travel arrangements has enabled the development of detailed travel impact environmental / scope 3 emissions reports.

The University Ethical Supply Chain policy has been updated to embrace latest policy developments and strengthen the focus on safe working conditions in supply chains.

Preparation is under way to issue the tender for property cleaning in early 2021. The tender will include carbon impact criteria.

Cardiff Met is leading dialogue between the Welsh Universities purchasing consortium (HEPCW) and NetPositive Futures regarding access for all HEPCW member institutions (including Cardiff Met) to the NetPositives 'supplier sustainability action plan' development portal. It is hoped agreement will be reached in January 2021 for access to the Net Positives platform in spring 2021. The platform currently holds records of over 600 Cardiff Met suppliers of whom over 500 have live sustainability action plans. Access to this data will not only help better inform Cardiff Met about activity in its supply chains but is also suitable for student research projects related to supply chain and sustainability projects.

STUDENTS' UNION

Objective

Increase awareness activities with students and the community

Target / Indicators

EVENTS

Number of sustainable awareness events / 1

Number of Fairtrade events / 3

Attendance at Cardiff Met Community Days / 4

Attendance at Global Week / 1

Number of events organised by Students' Union Part Time Environmental Officer / 1

Number of student litter picks organised by SU volunteering / 1

Numbers of sustainable stalls at fresher's fayre / 4

Numbers of events for Go Green week / 1

INITIATIVES

Numbers of Fairtrade Steering Group members / 3

Number of Sustainable societies / 1

Continue Fairtrade Status / Attain

Number of students taking part in the Cardiff Met Award, with the level:

- Health and Wellbeing / 2 of each
- Global Mind Set and Sustainable Thinking / 2 of each

AWARENESS

Number of social media posts

Number of students engaging over recycling bags / food waste bags

Number of initiatives introduced by the Students' Union

Number of Environmental Champions

Continue to hold the Social Enterprise Mark

Responsibility

Director of Students' Union



April 2020

There are ongoing sustainability events that the SU is involved in.

New Action Plan/Policy approved.

Environmental SU officer (KB) arranging an event for Go Green.

Volunteering week this week, Cardiff met award.

Thursday, event in Zen bar.

August 2020

Since mid March 2020 much of the operations of the Students Union have been closed down and we have operated with a small core team of staff and officers to support students both in terms of their academic requirements and their mental health and wellbeing. Many of our staff who would have been involved in environmental campaigns were put on furlough and remain so at the time of this report.



Jan 2021

Hosted an online talk from Swapabee

Submitted an application for a School orchard to natural Resources Wales

Liaising with our Enactus Society and Climate Change society to participate in the community garden Since mid March 2020 much of the operations of the Students Union have been closed down and we have operated with a small core team of staff and officers to support students both in terms of their academic requirements and their mental health and wellbeing. Many of our staff who would have been involved in environmental campaigns were put on furlough and remain so at the time of this report.

As a result many of the normal initiatives and campaigns that we would participate in or organise have had to be curtailed or postponed. Much of what we have done has been through online or virtual media given the restrictions in place on campus.

In reporting within our responsibilities in the Environmental Aspects, we have tried to provide a continued focus on environmental and sustainability issues and our Part Time Officer has provided us with information on the activities that they have undertaken.

Therefore whilst the report may not be as comprehensive or in the format of previous submissions it reflects what we have been able to do in very challenging circumstances.

Part Time Student officer Update. List of Activities Delivered / Planned

Drafted a sustainability guide for students

Social media postings on; walk to school month / world vegan day / Keep Wales tidy -12 days of Christmas / Veganuary / meatless Mondays / Wasteless Wednesdays.

Student Societies

In addition to the above, we have been working with our Enactus Society to set up a sustainable / healthy eating initiative in our Cyncoed Campus shop which will allow students and staff to purchase a range of products using their own containers. We have purchased all the POS, scales and printer for this and it will go live once students return to campus in full.

In addition we have approved 2 new societies within our School of Art and Design aimed at promoting the reuse of materials / art products in clothing etc. Similarly, there will be more progress to report on these once the students are able to undertake face-to-face meetings in a safe manner.

Students Union- General update

In September, we delivered a virtual freshers fayre in place of the event, which normally takes place in the National Indoor Athletic Centre and attracts over 4k students and exhibitors. This had a massive take up from both new and returning students and has remained as a live event throughout the first term.

We also went for a digital version only of our Essential Guide, which was e mailed out to all incoming students and was able to be accessed by all our International students. This has saved on printing and postage costs.

In previous years, we have provided a Christmas Market for students in the Llandaff Campus centre, and this year we moved this to on line version providing the opportunity for students and niche craft companies to promote their goods to the student body.

**SUSTAINABLE ESTATES
CONSTRUCTION, REFURBISHMENT, BIODIVERSITY**

Objective

Construction, Refurbishment, Biodiversity

Target

Net zero carbon by 2030 – target in NET ZERO CARBON action plan will encompass different aspects of the EMS.

Indicators

Improve external estate, increasing connectivity, wellbeing, biodiversity, pedestrian safety, aesthetics and social/informal learning - see Biodiversity Action Plan.

Plant at least 60 trees – 25 each at Cyncoed and Llandaff, 10 at Plas Gwyn.

Create new space for staff and student food growing, at all campuses.

Increase external seating areas by at least 20 spaces each at Cyncoed and Llandaff, 10 at Plas Gwyn.

Remove smoking shelters as Clean Air Policy starts in September 2020.

Create conservation area and walk in east/riverside wood at Llandaff.

Create new route to riverside at rear of Llandaff.

Replace central bike shelter at Llandaff with larger shelter using sustainable materials.

Additional living wall planting at Cyncoed and Llandaff.

Green front of Llandaff campus through additional turfing at roadside and sympathetic redecoration of key buildings.

Provide training/learning opportunities for beehives on both campuses.

Ensure sustainability at heart of new construction/campus redevelopment and estates strategy.

Responsibility

Director of Environment & Estates

April 2020

Planted 4 trees at Plas Gwyn.

Supplied planters for fruit trees to be planted in at Llandaff campus.

Turfing and benches fitted at front of campus.

Removal of smoking shelters on all sites.

40 Outdoor benches and tables with parasols installed at Llandaff and Cyncoed.

Additional living wall installed at Cyncoed including planting of 700 bedding plants in the green walls.

August 2020

Construction of timber outdoor, covered, spaces for social learning at Cyncoed and Llandaff. Removal of metal bicycle shelter from centre of campus.

Landscaping of the quad area at Cyncoed

60 trees planted at Llandaff to create a new orchard area.

Jan 2021

ARUP study on pedestrian access and safety at Llandaff produced 2019 – key recommendations have been reviewed and we have taken the opportunity to revisit the external environment in a Project we are calling, Greening of the Campus. This includes hard and soft landscaping, with a priority of pedestrians over vehicular access throughout the Campus. This will also incorporate

Decarbonisation works with solar panels, charging points, external seating areas and covered areas to create social and learning spaces, as well as increasing the landscaping and planting.

Proposal to develop new car route to rear of Llandaff being taken forward with Cardiff Council, to allow main precinct to be pedestrianised/greened – this is part of the Greening of the Campus.

Board informed November 19 of intention to be net zero carbon by 2030 – action plan being developed currently.

Removal of 40 parking signs from front of Llandaff campus over Christmas, new external seating, lighting, marked pedestrian route ways, opening out of woodland area to coincide with opening of CST Phase 1

New orchard and fruit planting as part of Enactus student project, with plans for larger growing schemes on both campuses. Awaiting delivery of 80 fruit trees.

PAPER & PRINT

Objective

Construction, Refurbishment, Biodiversity

Target

Monitor & educate top users (staff) for single-sided & colour print.

Measure and report on double-sided print across the fleet (monthly reporting).

Measure and report on colour print across the fleet (monthly reporting).

Measure and report on overall scanning volumes across the fleet (monthly reporting).

Indicators

Monthly reporting with top 5 users identified, contacted and information provided on methods to reduce consumption.

Baseline of 60% duplex.

Baseline of 65% mono.

Baseline of 500,000 scans per calendar year.

Responsibility

Commercial Services Manager

April 2020

Top 5 users identified for both single-sided print and colour print. Information & guides to be provided when university re-opens

Double sided print for the period was 62.9% (2.9% above baseline)

Mono print for the period was 73.3% (8.3% above baseline)

A total of 106,606 pages were scanned over this period

August 2020

Due to the closure of the university in March (COVID -19) the volume of print has been negligible for a skeleton of staff on campus. Many devices were not used at all during this period

With the start of the academic year at the end of September and the return of students to campus, print volumes will be monitored to establish the new normal level.

Jan 2021

Monthly reporting with top 5 users identified, contacted and information provided on methods to reduce consumption - Due to extraordinary operating during COVID-19 identify top users was not completed as print volumes are drastically reduced with very few staff on campus and many printers remaining unused, due to lack of resources within the Print Studio where staff have been furloughed and/or redeployed.

Baseline of 60% duplex – 60% achieved in this quarter

Baseline of 65% mono - 64% achieved in this quarter however due to the very low demand this is not representative of normal use.

Baseline of 500,000 scans per calendar year = quarterly total of 22,578 – in line with reduction in print volumes during COVID-19



ENVIRONMENTAL AWARENESS

Objective

Increase awareness activities, Campus and within Community

Target

To raise awareness of environmental and sustainability issues amongst Cardiff Met staff, students, stakeholders and local community with events and communication.

Maintain ISO 14001: 2015.

Improve standing in P&P Green League table.

Indicators

Monthly reporting on events type, number and impact.

Maintain continuous improvement with ISO 14001 and achieve zero non-conformities.

Improve on 68th from 2019 league.

Responsibility

Sustainability Engagement Manager

April 2020

Monthly reporting on events type, number and impact – During the reporting period events took place, with the assistance of a new post holder – Sustainability Projects Officer. Five Repair Cafes, 2x Community Days, Green Workshop, KESS2 Seminar, Business in Action Seminars, Sustainable Food Lecture, Volunteering Forum with Environmental Champions, Go Green Week, Litter Pick and Fair-trade Meetings. All events impact have been measured via social media platforms – with the introduction of Instagram during this period.

Maintain continuous improvement with ISO 14001 and achieve zero non-conformities – Successful external audit in January 2020 with no non-conformities raised.

Improve on 68th from 2019 league Sustainability Engagement – continuation of implementation of planned tasks for improvement in the league table and reporting to this Sustainability Committee

August 2020

No events took place during the reporting period due to covid-19 and Campus closure.

Maintain continuous improvement with ISO 14001 and achieve zero non-conformities – Successful external audit in January 2020 with no non-conformities raised.

Improve on 68th from 2019 league Sustainability Engagement – continuation of implementation of planned tasks for improvement in the league table and reporting to this Sustainability Committee.

Internal Audits have been completed as desktop exercise during Campus closure. Chemical and Hazardous substances will be audited when return to Campus.

Jan 2021

A number of events have taken place on Campus and online, Free Bike Servicing held in November x3 events, Litter picks x 7 at each Campus. Online – Hedgehog Friendly Campus, Single use coffee cups on Campus, Free Green Workshops – Wasteless Home & Wasteless Bathroom. Submission of Hedgehog Friendly Campus Bronze submission.

Maintain continuous improvement with ISO 14001 and achieve zero non-conformities – Next external audit in January 2021

Improve on 68th from 2019 league Sustainability Engagement – continuation of implementation of planned tasks for improvement in the league table and reporting to this Sustainability Committee. League on hold for 2020

ENERGY & UTILITIES

Objective

Increase awareness activities, Campus and within Community

Target

Reduce utility emissions to meet reduction targets (currently 3% per annum) as set out within Carbon Management Strategy.

Development of Carbon Management Plan project list to deliver aims of the Carbon Management Strategy, including prioritisation of projects for implementation.

Improve awareness of energy and utility consumption across the estate through regular targeted reporting of key data through meetings with schools.

Indicators

Reduce absolute carbon emissions from water by 10% by 2022/23, compared to the 2017/18 baseline. This is equal to a 2% reduction in water related CO2e emissions per annum.

Reduce absolute carbon emissions from energy by 15% by 2022/23, compared to the 2017/18 baseline. This is equal to a 3% reduction in energy related CO2e emissions per annum.

Net carbon zero by 2030 – action plan May 2020

Responsibility

Energy and Environment Engineer



April 2020

Estate wide electricity consumption over the period Jan – March 2019 showed continued improvements with a reduction of 7.6% compared to the same period last year, although the last 8-10 days of March after shutdown skews these values. Data does not include April 2020. YTD, electricity profiles are showing a reduction of 5% compared to last year which is ahead of the annual carbon reduction target but will need to be viewed with caution based on current circumstances with COVID-19. Although generally mild this winter, February was colder than last year and therefore, gas consumption represents an increase of 4.1% for this period and gas values are not influenced as much by the estate shut down towards the latter part of March due to longer running hours for hot water and some heating across buildings on the weekends prior to shutdown. YTD profiles on gas are currently sitting at 4.8% higher than the previous year resulting largely from the early months of Oct – Dec being much colder than last year. Estate wide water consumption over Jan-Mar is up by 14% compared to 2018/19 resulting primarily from a significant leak in Cyncoed that took some time to resolve. Overall water consumption is up by 16.7% YTD compared to last year as a result with general increases across all campuses also contributing to this.

Key projects currently underway – key projects currently in train are the upgrade of all external lighting across Llandaff and Cyncoed Campuses. Cyncoed has been completed and represents a 79% reduction in consumption overall compared to the previous fittings. Llandaff will be progressed next as soon as we are in a position to return to site. A feasibility review into upgrading the BMS in CSM to the new platform that's been rolled out across the rest of the estate is still ongoing.

Dashboards issued to Residences detailing monthly consumption were not utilised and feedback suggested they needed to be reviewed. A review of best practice energy reporting will be explored going forwards.

August 2020

As a result of the COVID 19 shutdown across the University estate, consumption of electricity has been confined largely to operational Residences blocks. Where viable, plant and equipment across all academic buildings was shutdown, however an electricity baseload remained across the estate for all connected buildings and IT servers to enable staff to work remotely. Estate wide YTD electricity consumption dropped by 14% compared to last year although it is now currently not accurate to draw performance comparisons with last year as a result of the impacts experienced by the lockdown. Electricity consumption reduced by 44% for the April-June period compared to the previous year. Bills for July have not yet arrived but are expected to portray a similar trend.

Estate wide YTD gas consumption (excluding July bills) has seen similar drops of 14% following the lockdown although despite demand for gas reducing over the summer months, consumption across the Estate between April and June reduced by 84% compared to the same period in 2019, largely due to disabling all heating in academic buildings across the University. Despite the impacts of COVID 19, water consumption still shows an increase of 1% YTD compared to last year. This is a result of elevated consumption throughout the year compared to last year and if the events of the previous months had not occurred, this increase would be much higher.

Estate wide water consumption over the Apr-Jun period is down by 48% compared to 2018/19.

Key projects currently underway – during the lockdown, improvements in lighting have been carried out in Llandaff CSM, Llandaff external lighting upgrades continue to be rolled out and a paper outlining the University's existing GHG Inventory is being developed to inform future actions that will contribute to the NET Zero Carbon Strategy. Improvements are also planned to upgrade lighting and controls in NIAC in the coming months.

Further research is being undertaken to develop more detailed consumption/cost analysis report

Jan 2021

As a result of the continued impacts of COVID 19 on occupancy across the University estate, consumption of electricity has reduced across all buildings. Student numbers in the first term were lower than expected and this led to a reduction in occupied spaces and lower demand for services. Estate wide YTD electricity consumption dropped by 23% compared to last year (Aug –Nov) although it is still currently not accurate to draw performance comparisons with last year as a result of the impacts experienced by the pandemic.

Heating demand across the estate has largely remained the same albeit set against the ventilation requirements to combat the spread of COVID 19 making buildings and teaching spaces uncomfortable for learning and teaching and heating less effective. Despite this, reduced services, shorter operating hours and less demand for sports facilities has resulted in lower gas consumption. Estate wide YTD gas consumption has dropped by 30% to end October (Nov bills not in), also aided by relatively mild weather conditions for the autumn months. Following the start of term and with less students and staff onsite, water consumption reduced by 34% YTD compared to last year over the Aug-Nov period.

Key projects currently underway – further improvements in lighting have been carried out in Llandaff CSM, Llandaff external lighting upgrades continue to be rolled out and a paper outlining the University's existing GHG Inventory has been submitted to inform future actions that will contribute to the NET Zero Carbon Strategy. NIAC computer based lighting controls have been replaced with manual switching as a more user friendly solution together with improved LED floodlights over key areas in the arena. New lighting has been installed to the front of Llandaff carpark and walkway enhancing the lighting in that area. Feasibility study into retrofitting a heat pump heating system into Llandaff N Block is also being undertaken. Key input into electrical and mechanical specifications and installation for Llandaff CST Phase 2 to reduce energy consumption. Development of a Standardised Lighting Specification for the University to be utilised across refurbishment and new build projects. Analysis of scope 3 emissions and gap analysis - working with Procurement on establishing goods and services footprint. Development of tender specification for the upgrade of CSM BMS. Inclusion of RICS SKA as a pilot in CST Phase 3 as a self-assessed sustainable assessment tool.

Further research is being undertaken to develop more detailed consumption/cost analysis reports.

EMISSIONS & EFFLUENTS

Objective

Legislation Compliance / Best Practice

Target

Compliance with Legislation /Best Practice, Drainage Discharge, Emissions to Air, Drainage, Air Conditioning, Lev's and Fume Cupboards, Water Treatment / Control of Legionella.

Indicators

Recording of Compliance with Legislation and Best Practice for Drainage Discharge; Emissions to Air; Drainage; Air Conditioning; Lev's and Fume Cupboards and Water Treatment / Control of Legionella, checking via internal student audits and ensuring compliance through our legislation update service.

Responsibility

Maintenance and Space Operations Manager

April 2020

Student Auditors completed their Emissions to Air audit this quarter. All planned maintenance regime in full operation in Jan – March 2020, due to Campus closure all planned maintenance has ceased since Campus closure. Residences continue to test in their areas. Building closures and re-opening protocol in place. This protocol addresses the legal requirements for re-opening Campus..

August 2020

We have received letters of exemption for Emissions to Air Certificate from Share Regulatory Services and authorisation given to discharge wastewater into public foul sewers by Welsh Water in July 2020.

Due to Coronavirus and the closure of the University, we have carried out water flushing on all sites and continued with contract services which include temperature monitoring, legionella sampling, tank cleaning and showerhead cleaning. LEV's and fume cupboards haven't been in use but all servicing and maintenance has continued. Servicing and maintenance has also continued on air handling units/air conditioning units.

Jan 2021

We have received letters of exemption for Emissions to Air Certificate from Share Regulatory Services and authorisation given to discharge wastewater into public foul sewers by Welsh Water in July 2020.

Due to Coronavirus and the closure of the University, we have carried out water flushing on all sites and continued with contract services which include temperature monitoring, legionella sampling, tank cleaning and showerhead cleaning. LEV's and fume cupboards haven't been in use but all servicing and maintenance has continued. Servicing and maintenance has also continued on air handling units/air conditioning units.

CHEMICALS & HAZARDOUS SUBSTANCES

Objective

Control of chemical & hazardous substances

Target

Monitoring the implementation of the Cardiff Met Environment Good Practice Use of Chemicals Protocol within the University's schools/units.

Indicators

Recording of number of completed internal audits collectively completed between health & safety inspections and internal /external environmental audits per term.

Responsibility

Head of Health and Safety

April 2020

Will expand the newly developed University code of good practice to all areas of the University.

Targets will demonstrate collaboration between health and safety inspections and environmental audits. Confirm target numbers for each term.

August 2020

Limited progress has been made during the period as the H&S audit programme initially focused on a review of the University's fire safety management following a directive from Welsh Government and latterly was suspended due to C-19.

Jan 2021

This work is currently suspended and has been since March 2020 lockdown. During the lockdown period there has been limited activity on campuses. As the campuses become reoccupied the monitoring of this aspect will restart

ACADEMIC DEVELOPMENT

Objective

Promotion of Environmental studies

Target

To initiate an investigation into how many courses currently contain components of sustainability within the University.

To scope out how sustainability could be incorporated into the future QED CPD offering as part of the current CPD review, including evaluation processes e.g. through workshop feedback/ staff self-reporting on activities /validation processes.

Responsibility

Learning Development Officer

SUSTAINABLE RESEARCH

Objective

Academic research and consultancy relating to environmental topics

Target

Completion of an annual report summarising academic research and consultancy undertaken by the University

Indicators

Completion of an annual report summarising academic research and consultancy undertaken by the University

Responsibility

Director of Research and Graduate Studies

April 2020

Academics are being contacted about getting involved in the education side of sustainability.

New case studies provided for webpages

August 2020

No progress made with target due to covid 19 focus to move to online teaching.

Jan 2021

No progress made with target due to covid 19 focus to move to online teaching.

April 2020

Annual Report content submitted

August 2020

Annual Report content submitted

Jan 2021

Contribution to annual report provided. Cardiff Met's official launch of the first three Global Academies earlier this month will have a further influence in developing the theme of interdisciplinarity, including for areas of interest linked to environmental sustainability.

CONCLUSION

The University continues to make excellent progress on the environment and sustainability agenda and thanks are due to the staff and students for their contribution. Its pursuit of becoming a top 10 university in the next five years opens up further challenges. There are many examples where the University makes a difference, but it can do more. This is a great opportunity to lead in pushing forward the principles of sustainable development. By committing to the sustainable development agenda, Cardiff Metropolitan University can win the hearts and minds of staff and students, create positive impacts, shift the culture from compliance to alliance and drive up performance and invest in the future.

The changes brought about by the pandemic and ways of working will result in a review of our Sustainability Strategy, targets and objectives, through new opportunities identified.

As the University is not a public body, it does not have to comply with reporting on the Well-being of Future Generations (Wales) Act, but we still face the same challenges, to tackle these we need to work together with public bodies to give current and future generations a good quality of life. We need to think and consider the long-term impact of the decisions we make as a University.

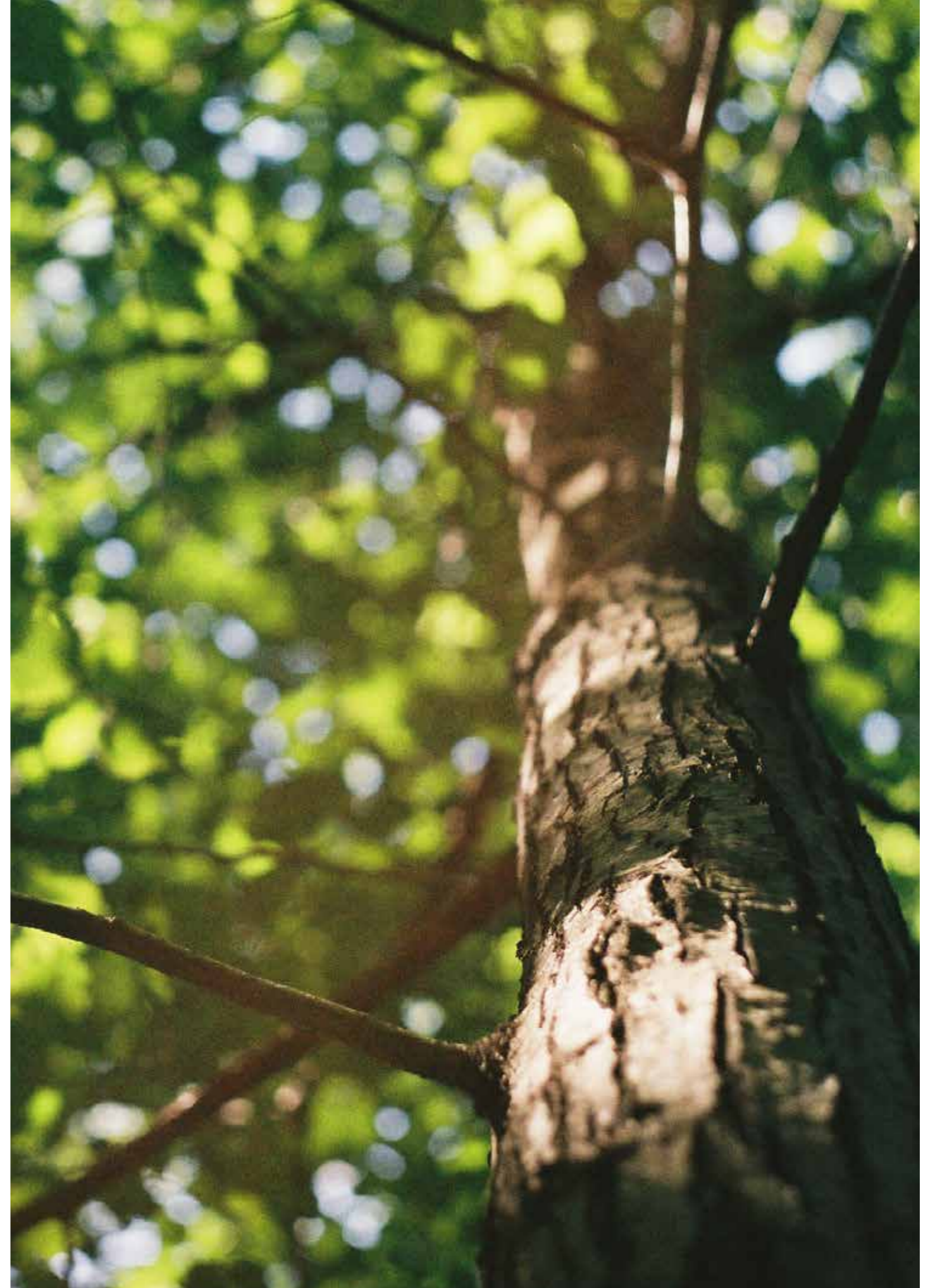

FOCUS 2021 ONWARDS

Future focus may include but not be limited to :

Publish our strategy for achieving Net Zero Carbon by 2030, including interim targets to 2026 to help monitor progress.

Develop an electric vehicle charging strategy for the estate and transition our fleet from fossil fuels to electric.

Undertake a strategic Solar PV study to understand opportunities for expanding solar PV generation capacity across the estate as with price competitiveness and paybacks increasingly attractive.

Undertake feasibility studies into zero/low carbon upgrades of plant, starting with a pilot study on one of our academic buildings.

Continue with LED lighting upgrades, with further projects targeted in our sports facilities and high consuming buildings.

Continued focus on data capture and improved accuracy to support transparency of data reporting and action planning.

Explore opportunities for pursuing Power Purchase Agreements (PPA's) to increase the proportion of our electricity that comes from renewable and sustainable sources.

Determine the environmental impacts of increased homeworking and its net impact on energy use.

Undertake improvements to the collection, processing and reporting of scope 3 data across the University to inform a more accurate Green House Gas Inventory baseline on our carbon footprint.

Develop a water management plan.

Continue with WRAP agreement – for the delivery of the UK Food Waste Reduction (FWR) Roadmap – to embed the principles of target, measure, act within our food operations

Implementation of a Green / electric pool vehicle fleet

Implementation of a single use coffee cup levy fee, with raised funds supporting further sustainability initiatives in the University

Investigate new car share resource to aid staff

Local community engagement with Repair Café and litter picks in Campus' community

Delivery of Orchard proposal for the Enactus Society

Review of all opportunities for the University to submit applications for Sustainability Awards

Further opportunities to extend the number of Next Bikes for all Campuses

Implementation of single use coffee cup waste stream for collection at Cyncoed Campus

The reduction of single use plastic for food and drink containers through the University Catering service

Introduction of a range of re-usable food and drink products throughout all University Catering outlets

Continual improvement of Environmental Management System (EMS) to adhere to ISO 14001 : 2015

To develop and focus the Community Days each month (term time). The promotion EMS Aspect areas by continuing to raise awareness of University environmental initiatives on Campus and ideas for behavioural change and promotion of local Community partners

Further develop sustainable engagement activities with Community Groups

Further develop the Repair Café Wales promotion for events at both Campus' during Community Days

Bees arrival August 2019 – implementation of training programme and introductory sessions for staff / students and the local community on Campus

The continuation of free Green Workshops for staff and students together to attend taster sessions of green living opportunities

Further opportunities for students to engage and train as Internal Auditors of the Environmental Management System and complete internal audits in student teams

Creation of a Communication Plan to develop and programme all Aspect Owner areas of engagement with staff, students and local community

Volunteering of staff and students to support Green events, e.g. Go Green Week, working groups, Litter picks and Repair Cafes

Work to review emphasis on agile working to provide significant benefits to the University's sustainability, as we review and reduce our space needs

Review of external space, seating and signage around the Campus

Review of Fairtrade Policy and renewal

Maintain and improve Sustainable Restaurant Award

Extending Real World projects to all Schools

Working with environmental SU societies, Climate Change Society

Further opportunities for students to complete work placements with Sustainability Engagement Manager and Environment & Estates, working on feasibility of sustainability projects and plans.

All Estates projects to consider all sustainability options throughout all projects

Improvements with HESA/EMR data collection for Travel

Procurement focus - supply chain logistics consolidation; upcycling and recycling; the use of less harmful materials, chemicals and manufacturing processes; products manufactured from post-consumer waste; continuing to promote energy efficiency as a significant factor in the evaluation of relevant procurement activity; further enhancement of transparency in its extended supply chains to help deliver greater social and environmental benefit

Continuation with Hedgehog Friendly Campus work for Bronze Award receipt in Jan 2021 and progress onto Silver in Jan 2022

Working with local, national and international groups and organisations to promote sustainable ideas, behaviours and initiatives

Reverse Vending. This will be a pilot to implement Plastic bottle recycling within the Atrium at Llandaff and The Bench at Cyncoed

Identify and Rationalise Waste Bins

Completion of Fairtrade application for Spring 2022

Collaborate with Cardiff Council on the development of a Cycle Superhighway system to link large areas of the city to promote active travel

Green our Campus strategy consultations

In the coming twelve months, the University will be seeking further opportunities for:

Supply chain logistics consolidation.

Upcycling and recycling

The use of less harmful materials, chemicals and manufacturing processes

Products manufactured from post-consumer waste

Continuing to promote energy efficiency as a significant factor in the evaluation of relevant procurement activity;

Further enhancement of transparency in its extended supply chains to help deliver greater social and environmental benefit.

Using the data from the NetPositives portal to develop detailed information and targets for sustainability in its direct and extended supply chains.



A close-up, blurred photograph of green grass blades against a dark background, creating a sense of motion and depth. The blades are oriented diagonally across the frame.

GET IN TOUCH
WITH US

WWW.CARDIFFMET.AC.UK/ABOUT/SUSTAINABILITY

SUSTAINABILITY@CARDIFFMET.AC.UK